

FOUNDATION PLAN  
A-2 SCALE: 1/4"=1'-0"

FOUNDATION PLAN NOTES:  
 1. ALL FOUNDATION WALLS TO BE CONCRETE ON GRADE.  
 2. ALL FOUNDATION WALLS TO BE 12" MIN. THICK CONCRETE.  
 3. ALL FOUNDATION WALLS TO BE REINFORCED WITH #4 BARS @ 18" O.C.  
 4. ALL FOUNDATION WALLS TO BE FINISHED WITH 1/2" GYPSUM BOARD.  
 5. ALL FOUNDATION WALLS TO BE PAINTED WITH 2 COATS OF EXTERIOR GRADE PAINT.  
 6. ALL FOUNDATION WALLS TO BE PROTECTED WITH 6" POLYSTYRENE INSULATION.  
 7. ALL FOUNDATION WALLS TO BE PROTECTED WITH 6" POLYSTYRENE INSULATION.  
 8. ALL FOUNDATION WALLS TO BE PROTECTED WITH 6" POLYSTYRENE INSULATION.  
 9. ALL FOUNDATION WALLS TO BE PROTECTED WITH 6" POLYSTYRENE INSULATION.  
 10. ALL FOUNDATION WALLS TO BE PROTECTED WITH 6" POLYSTYRENE INSULATION.

STATISTICS:	
AREA:	EXISTING: PROPOSED:
FIRST FLOOR AREA:	N/A 1,807 S.F.
SECOND FLOOR AREA:	N/A N/A
TOTAL LIVING AREA:	N/A 1,807 S.F.
BASEMENT AREA:	N/A 1,630 S.F.
GARAGE AREA:	N/A 499 S.F.
TOTAL AREA:	N/A 3,936 S.F.

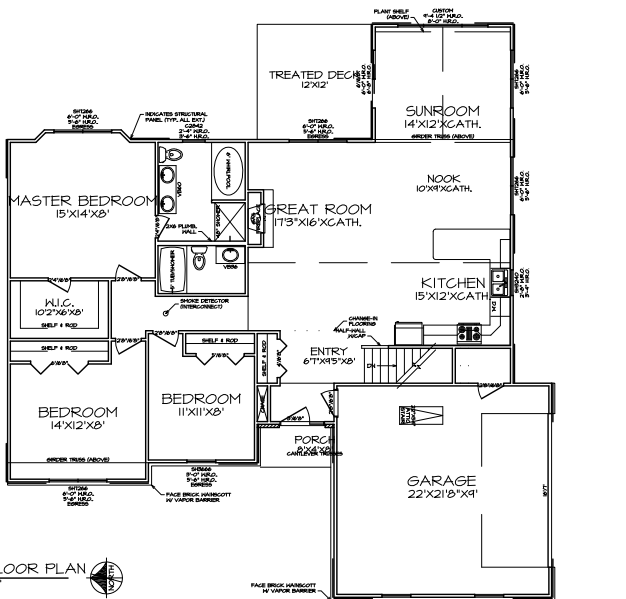

FIRST FLOOR PLAN  
A-3 SCALE: 1/4"=1'-0"

FIRST FLOOR PLAN NOTES:  
 1. ALL CEILING SYSTEMS TO HAVE 22' DIA. 4" R-13 BATT INSULATION.  
 2. ALL CEILING SYSTEMS TO HAVE 22' DIA. 4" R-13 BATT INSULATION.  
 3. ALL CEILING SYSTEMS TO HAVE 22' DIA. 4" R-13 BATT INSULATION.  
 4. ALL CEILING SYSTEMS TO HAVE 22' DIA. 4" R-13 BATT INSULATION.  
 5. ALL CEILING SYSTEMS TO HAVE 22' DIA. 4" R-13 BATT INSULATION.  
 6. ALL CEILING SYSTEMS TO HAVE 22' DIA. 4" R-13 BATT INSULATION.  
 7. ALL CEILING SYSTEMS TO HAVE 22' DIA. 4" R-13 BATT INSULATION.  
 8. ALL CEILING SYSTEMS TO HAVE 22' DIA. 4" R-13 BATT INSULATION.  
 9. ALL CEILING SYSTEMS TO HAVE 22' DIA. 4" R-13 BATT INSULATION.  
 10. ALL CEILING SYSTEMS TO HAVE 22' DIA. 4" R-13 BATT INSULATION.

GALLIVAN'S  
 DRAFTING & DESIGN  
 (217) 202-5998

1807SF1SB.dwg